



# FACILITIES MASTER PLAN

---

*Academic Senate*  
*November 20, 2024*



# The Planning Team

**DLR**GROUP



**Leigh Anne Jones**  
Principal In Charge



**Linsey Graff**  
Senior Campus Planner



**Kallie Greenshields**  
Project Coordinator



**Amy Triscoli**  
Campus Planner



**Jason Jewell**  
Project Manager



**Cody-Michael Gan**  
Campus Planner – Graphics  
+ Documentation



**Kaelyn Bowers**  
Campus Planner – Graphics +  
Documentation



**Mario Cipresso**  
Urban Design & Architecture



# ABOUT THE FACILITIES MASTER PLAN



# Meetings To Date - SBVC Facilities Master Plan 2024

FEB	<b>President's Cabinet</b>	Kick-Off, Process, & Schedule	Feb 27th
MAR	<b>College Council</b>	Visioning Session	Mar 13 <sup>th</sup>
	<b>Open Forum</b>	Visioning Session [Virtual]	Mar 26 <sup>th</sup>
	<b>Open Forum</b>	Visioning Session [In-Person]	Mar 28 <sup>th</sup>
APR	<b>College Council</b>	Needs and Analysis Workshop	Apr 10 <sup>th</sup>
	<b>Management</b>	Needs and Analysis Workshop	Apr 18 <sup>th</sup>
	<b>President's Cabinet</b>	Needs & Analysis Workshop Debrief	Apr 30 <sup>th</sup>
MAY	<b>Academic Senate</b>	FMP Progress Report and Feedback Request	May 1 <sup>st</sup>
	<b>College Council</b>	Big Ideas Workshop	May 8 <sup>th</sup>
	<b>Associated Student Government</b>	FMP Progress Report and Feedback Request	May 10 <sup>th</sup>
	<b>Classified Senate</b>	FMP Progress Report and Feedback Request	May 10 <sup>th</sup>
SEP	<b>President's Cabinet</b>	Concept Design Review	Sep 3 <sup>rd</sup>
	<b>Open Forum</b>	Concept Design Review [Virtual]	Sep 17 <sup>th</sup>
	<b>Open Forum</b>	Concept Design Review [In-Person]	Sep 19 <sup>th</sup>
OCT	<b>President's Cabinet</b>	Phasing and Funding	Oct 15 <sup>th</sup>

Continued...

# Upcoming Meetings - SBVC Facilities Master Plan 2024

NOV ●

<b>College Council</b>	Introduction of the FMP First Draft	Nov 13 <sup>th</sup>
<b>Classified Senate</b>	First Read of the Draft FMP	Nov 15 <sup>th</sup>
<b>Academic Senate</b>	First Read of the Draft FMP	Nov 20 <sup>th</sup>
<b>Associated Student Government</b>	First Read of the Draft FMP	Oct 31 <sup>st</sup>
<b>President's Cabinet</b>	Review Feedback and Provide Direction	TBD

DEC ●

<b>Academic Senate</b>	Final FMP Approval	Dec 4 <sup>th</sup>
<b>Classified Senate</b>	Final FMP Approval	TBD
<b>Associated Student Government</b>	Final FMP Approval	TBD
<b>College Council</b>	Final Plan Presentation	TBD
<b>Open Forum</b>	Final Plan Presentation [Virtual]	Dec 9 <sup>th</sup>
<b>Open Forum</b>	Final Plan Presentation [In-Person]	Dec 11 <sup>th</sup>
<b>President's Cabinet</b>	Board Preparation	Dec 17 <sup>th</sup>



# Setting the Context

## • Previous Plans & Studies

- 2017 Campus Master Plan
- 2018 Sewer System Management Plan
- 2020 Utility Master Plan
- 2021 Land Acquisition Visioning Document
- 2022 Updated Land Acquisition Visioning Document
- 2023 -2028 Education Master Plan
- 2023 Sustainability Plan
- 2023 Landscape Master Plan
- 2024 Wayfinding Master Plan
- ZNE Plan
- Five-Year Construction Plan
- Waste Management Plan

## Engagement with Campus Community

- SBVC Virtual Open Forum, March 26<sup>th</sup>, September 17<sup>th</sup>
  - SBVC In-Person Open Forum, March 28<sup>th</sup>, September 19<sup>th</sup>
  - Academic Senate, May 1<sup>st</sup>, November 20<sup>th</sup>, December 4<sup>th</sup>
  - College Council, May 8<sup>th</sup>, November 13<sup>th</sup>, December
  - Special Senate, May 9<sup>th</sup>
  - Classified Senate, May 10<sup>th</sup>, November 15<sup>th</sup>, December
  - Student Senate, October 31<sup>st</sup>
- **Space Utilization and Space Needs**
  - **Facilities Condition Assessment**





# Why do a Master Plan?

- Create a **vision** for the future that aligns with the **strategic direction** of the College
- Create a **guide for development** for the next **10+ years (starting in 2027)**
- Establish a basis for **informed decision-making** going forward
- Strengthen **relationships** within the campus and with the community
- Provide a **roadmap and tools** for implementation





# Phase 00 Projects - Funded

## New Construction

1. Career Pathways 1: Applied Technology Building Replacement
2. Student Services Building
3. Career Pathways 2: Aeronautics
4. Career Pathways 2: Allied Health
5. Career Pathways 2: Welding
6. Softball Field

## Renovation

7. Administrative Building and Lois Carson Campus Center Repurpose
8. Old Central Plant Repurposing

## Demolition

- Tech Building
- Liberal Arts Building

## Campus-Wide

- Irrigation Upgrades
- Utility Upgrades
- Infrastructure Upgrades\*



- New Construction
- Renovation

\*Infrastructure and additional projects include:

- Campus-wide Roof Replacement
- Biology Garden Expansion
- Landscape Master Plan
- Wayfinding Master Plan
- EV Charging Stations
- Old Central Plant Repurpose
- Campus-Wide Utility Upgrades
- Observatory Investigation
- Marque Replacement
- Fiber Updates
- Irrigation Controller Replacement
- Campus-wide Security Migration
- Gym Lobby Flooring
- Retro-Commissioning
- New Scoreboard at Baseball/Soccer Field
- Planetarium HVAC Replacement
- PS & HLS Mechanical Improvements
- Perimeter Fencing
- East Wing Mechanical Upgrades





## Base Condition

*Our planning assumes that the Phase 00 projects are complete, including the Student Services Building, Applied Technology Building, Aeronautics Building, Allied Health Building, and Welding Building.*





# District-wide Facilities Master Plan Themes

## **1. MODERNIZE FACILITIES:**

---

*Modernize existing facilities to propel excellence and community prosperity.*

## **2. RIGHT-SIZE & MAXIMIZE EFFICIENCY:**

---

*Right-size and equitably redistribute space and services to maximize efficiency and respond to trends in higher education.*

## **3. FOSTER A SUSTAINABLE FUTURE:**

---

*Ensure development addresses each of the goals within the Sustainability Plan, prioritizing resource conservation and the well-being of people and the planet.*

## **4. DESIGN FOR SAFETY & INCLUSIVITY:**

---

*Design a built environment that fosters a safe and welcoming setting for students, faculty, and staff.*

## **5. BUILD COMMUNITY & FOSTER COLLABORATION:**

---

*Create spaces for events and daily gatherings to build community and foster collaboration.*

## **6. IMPROVE BRANDING, WAYFINDING, ART:**

---

*Improve branding, wayfinding, and public art to strengthen SBCCD's identity.*

## **7. CREATE FLEXIBLE CLASSROOMS & SUPPORT ACTIVE LEARNING:**

---

*Design classrooms for flexibility and active learning to facilitate a collaborative learning environment.*

*These all-encompassing themes have emerged in our engagement and data analysis.*

*They apply to each College and the district facilities and space – you'd do these anywhere.*



# Concept Plan

**Bolster and define facilities that support community programming, gathering, and events**

**Address key renovations infrastructure improvements, demolitions, and opportunities within vacated space**

**Support the unique character and identity of the campus through beautification and functional outdoor programs and amenities**

**Enhance arrival and wayfinding and create an efficient, multi-modal circulation network**

**Create space for new and immersive academic programs that align with industry needs and support hands-on learning.**





# Concept Plan

**Bolster and define facilities that support community programming, gathering, and events**

Address key renovations infrastructure improvements, demolitions, and opportunities within vacated space

Support the unique character and identity of the campus through beautification and functional outdoor programs and amenities

Enhance arrival and wayfinding and create an efficient, multi-modal circulation network

Create space for new and immersive academic programs that align with industry needs and support hands-on learning.

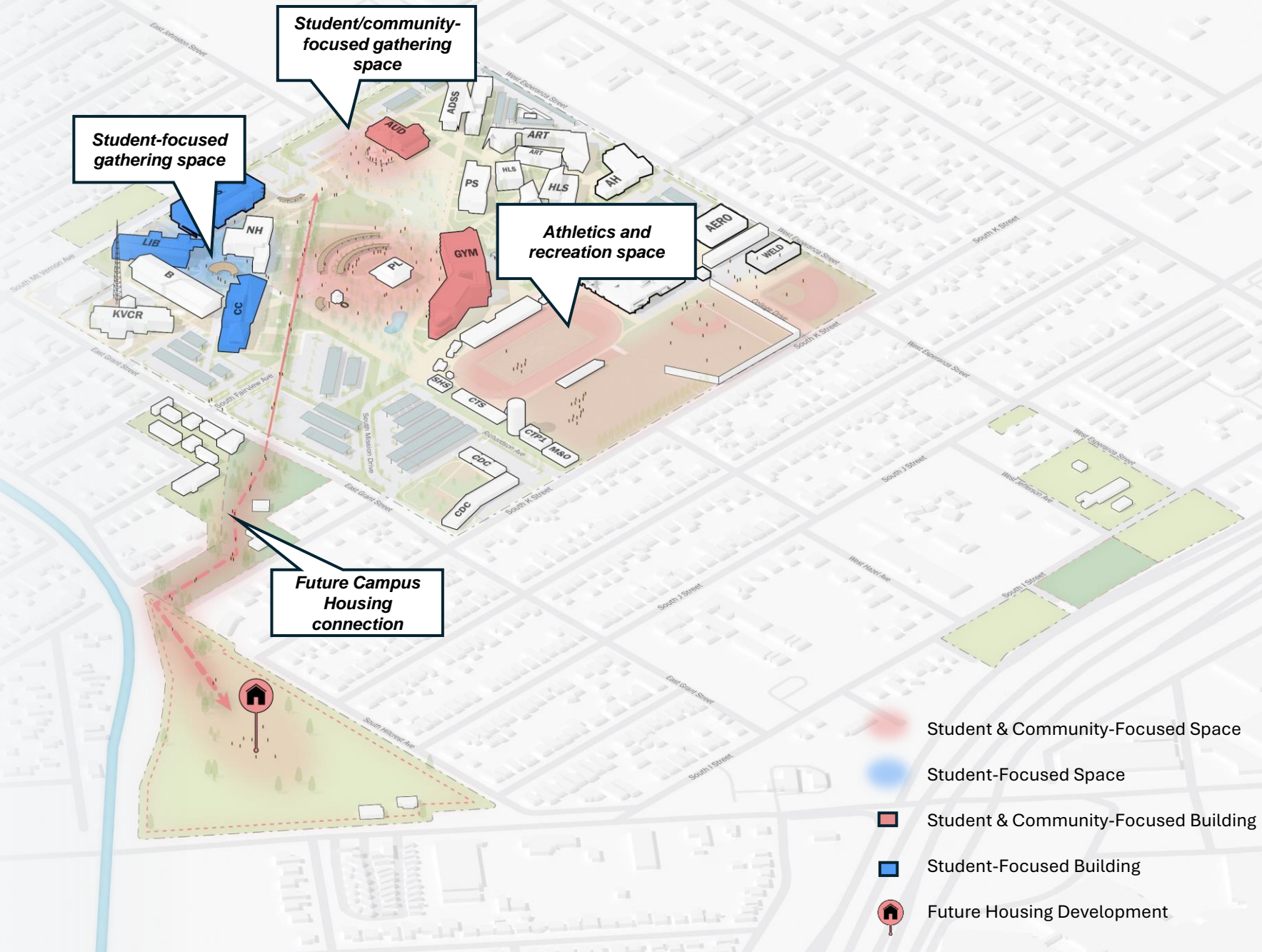



# Concept Plan

Bolster and define facilities that support community programming, gathering, and events



Address key renovations infrastructure improvements, demolitions, and opportunities within vacated space

Support the unique character and identity of the campus through beautification and functional outdoor programs and amenities

Enhance arrival and wayfinding and create an efficient, multi-modal circulation network

Create space for new and immersive academic programs that align with industry needs and support hands-on learning.



-  FCI > 10% in next 5 years
-  Future target for demolition
-  Future target for renovation due to vacant space or key program



# Concept Plan

Bolster and define facilities that support community programming, gathering, and events

Address key renovations infrastructure improvements, demolitions, and opportunities within vacated space

Support the unique character and identity of the campus through beautification and functional outdoor programs and amenities

Enhance arrival and wayfinding and create an efficient, multi-modal circulation network

Create space for new and immersive academic programs that align with industry needs and support hands-on learning.

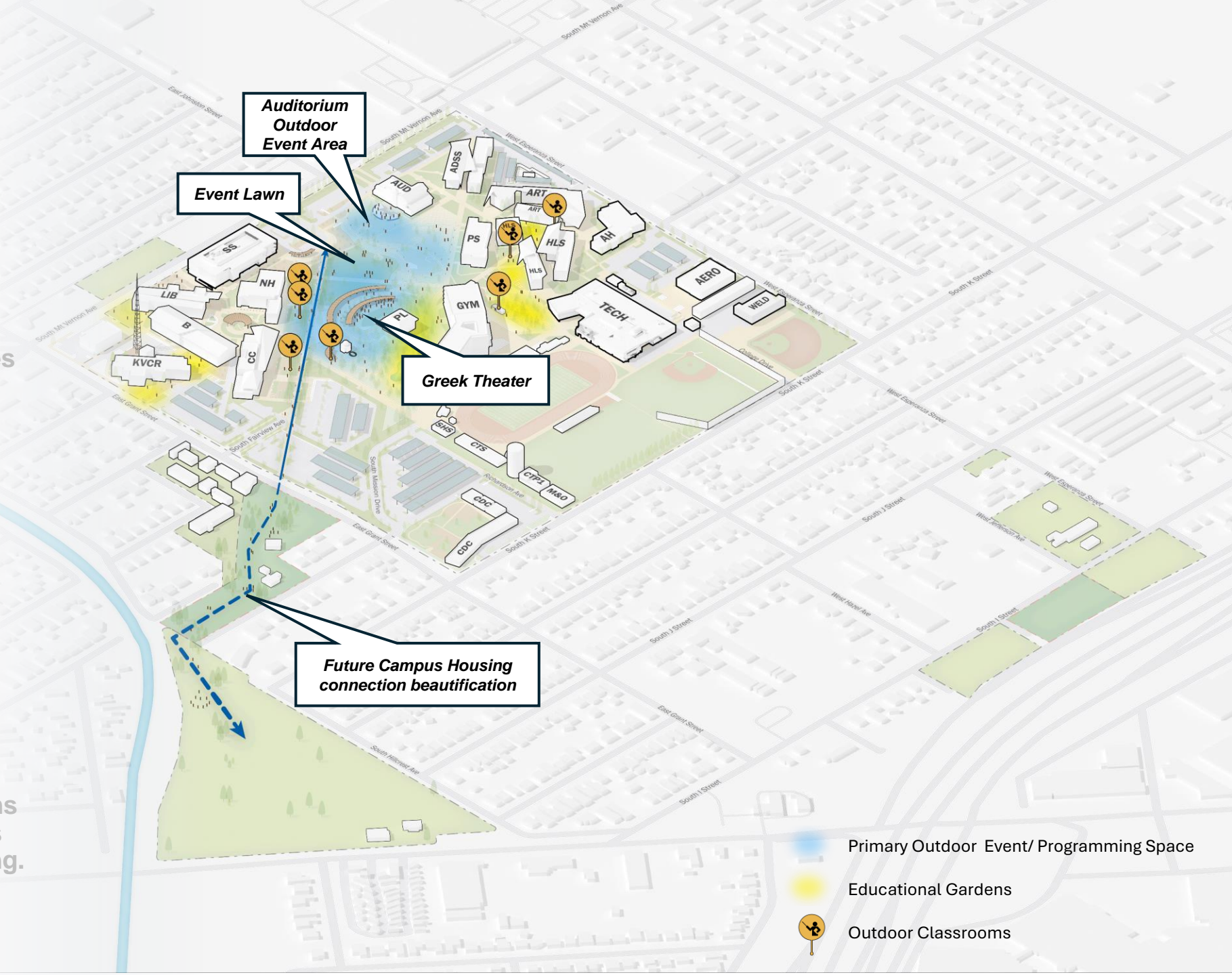

-  Primary Outdoor Event/ Programming Space
-  Educational Gardens
-  Outdoor Classrooms



# Concept Plan

Bolster and define facilities that support community programming, gathering, and events

Address key renovations infrastructure improvements, demolitions, and opportunities within vacated space

Support the unique character and identity of the campus through beautification and functional outdoor programs and amenities

Enhance arrival and wayfinding and create an efficient, multi-modal circulation network

Create space for new and immersive academic programs that align with industry needs and support hands-on learning.

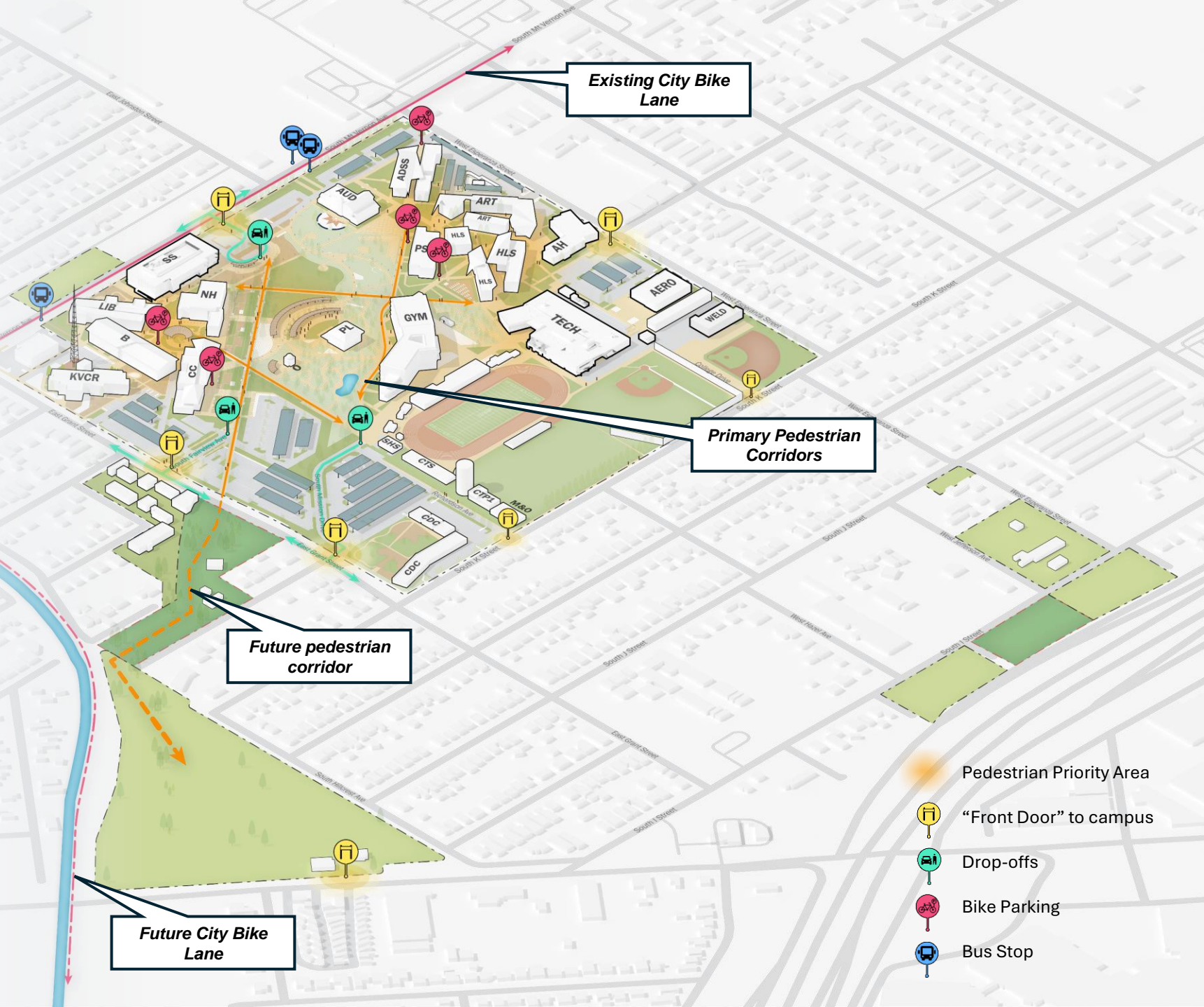



# Concept Plan

Bolster and define facilities that support community programming, gathering, and events

Address key renovations infrastructure improvements, demolitions, and opportunities within vacated space

Support the unique character and identity of the campus through beautification and functional outdoor programs and amenities

Enhance arrival and wayfinding and create an efficient, multi-modal circulation network

**Create space for new and immersive academic programs that align with industry needs and support hands-on learning.**

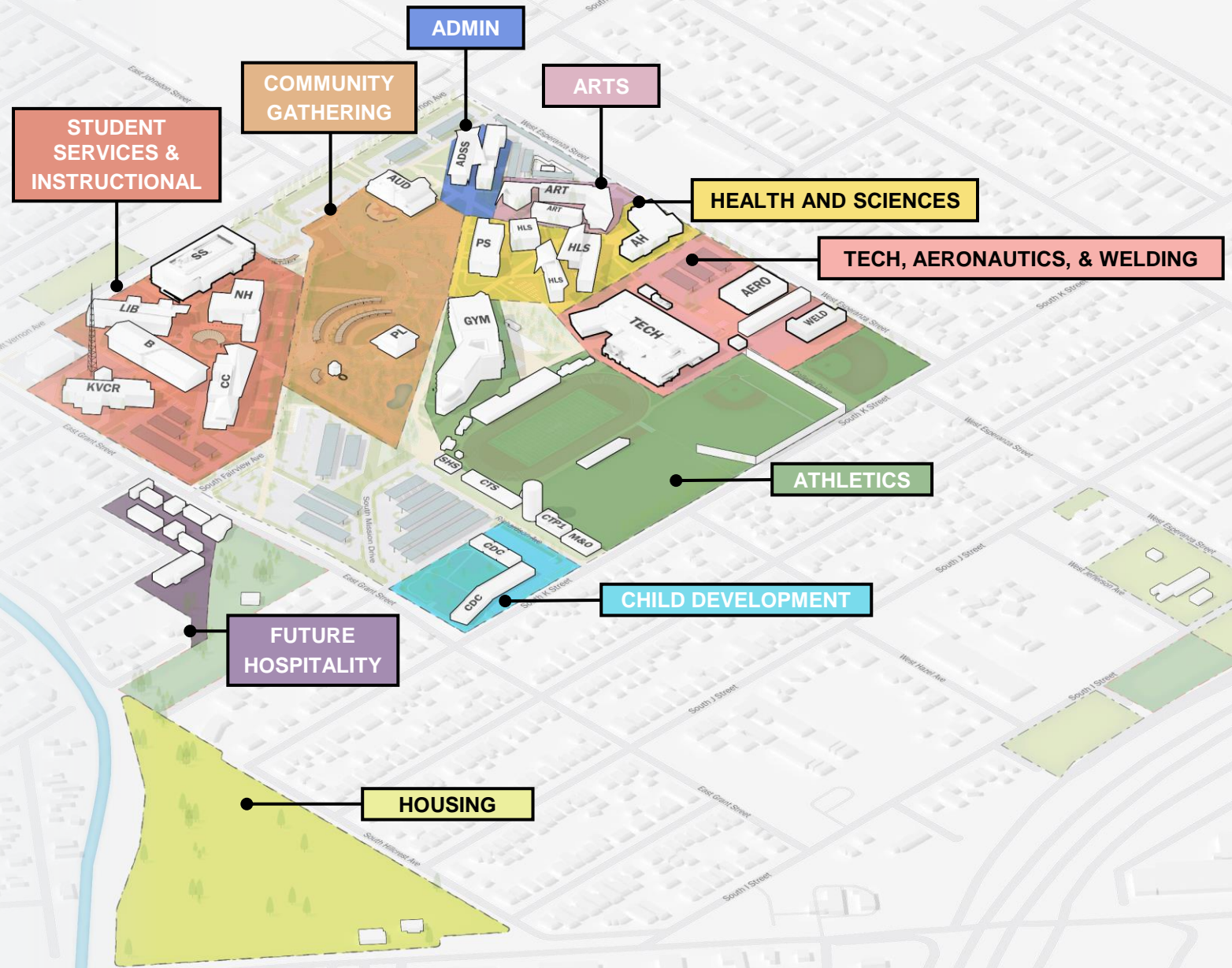





# VISION PLAN





## New Construction

1. Campus and Community Resource Hub
2. Mixed-Use Site with Housing
3. Hospitality Hub
4. CDC & Parent Ed. Building
5. KVCR Additions
6. Community Hub

## Renovation

7. M&O Building (Former Transportation)
8. Library Repurposing
9. Greek Theater & Planetarium
10. Health Life Sciences
11. Lois Carson Campus Center – PD Space
12. Renovation of Athletic Fields/Facilities\*

## Demolition

- Warehouse (Parent Ed Center, Shipping & Receiving, Police Storage, Warehouse, and Storage Buildings)
- CTS
- SHS

## Campus-Wide

- Alignment with Sustainability Plan
- Placemaking in the Exterior Environment\*\*
- Active Learning Classroom Retrofits
- Circulation and Parking
- Infrastructure



 **New Construction – Building**

 **New Construction – Parking Structure**

 **Renovation**

 **Demolition**

\*Includes: turf fields, stadium field renovation, track resurfacing, baseball stadium renovation

\*\*Includes Fault Promenade, Geology Garden, outdoor classrooms, and other Landscape Master Plan projects

\*\*\*Future programs may include Drone Tech., Construction Tech., Nursing expansion, and Veterinary Tech.

**Future Programs\*\*\* and CTE**



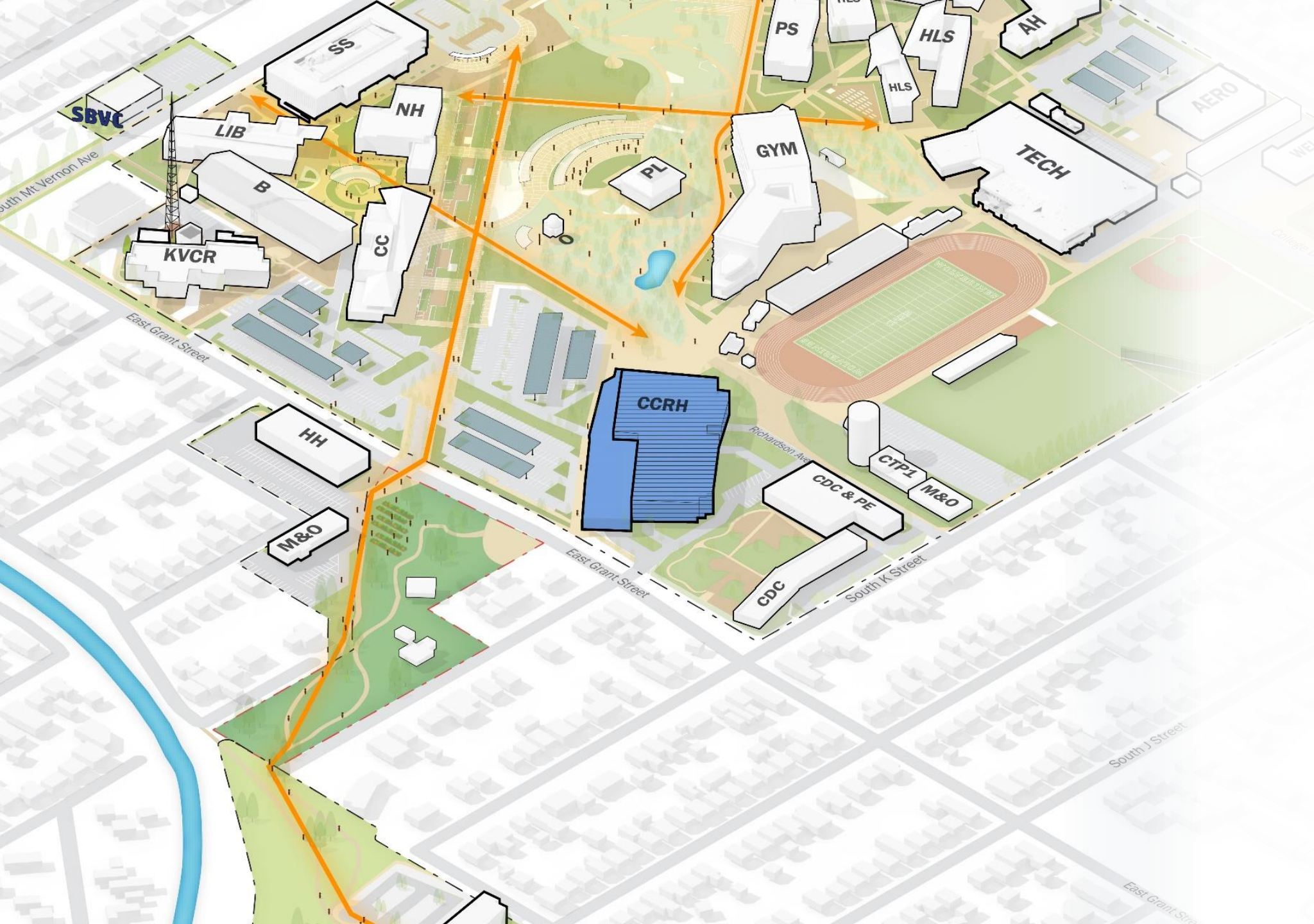

## Campus and Community Resource Hub

- Size:**
- 65,000 GSF Mixed Use Liner
  - ~690 parking stalls

- Programs:**
- Police Department
  - Printing Services
  - Warehouse
  - Offices uses
  - Police Academy Space
  - Program Expansion Space

- Sustainability:**
- Solar PV on roof
  - Design for LEED/ZNE
  - Site / Stormwater Improvements

- Alignment with Education Plan:**
- Relocate non-student facing functions from core.
  - Support parking that supports community and students

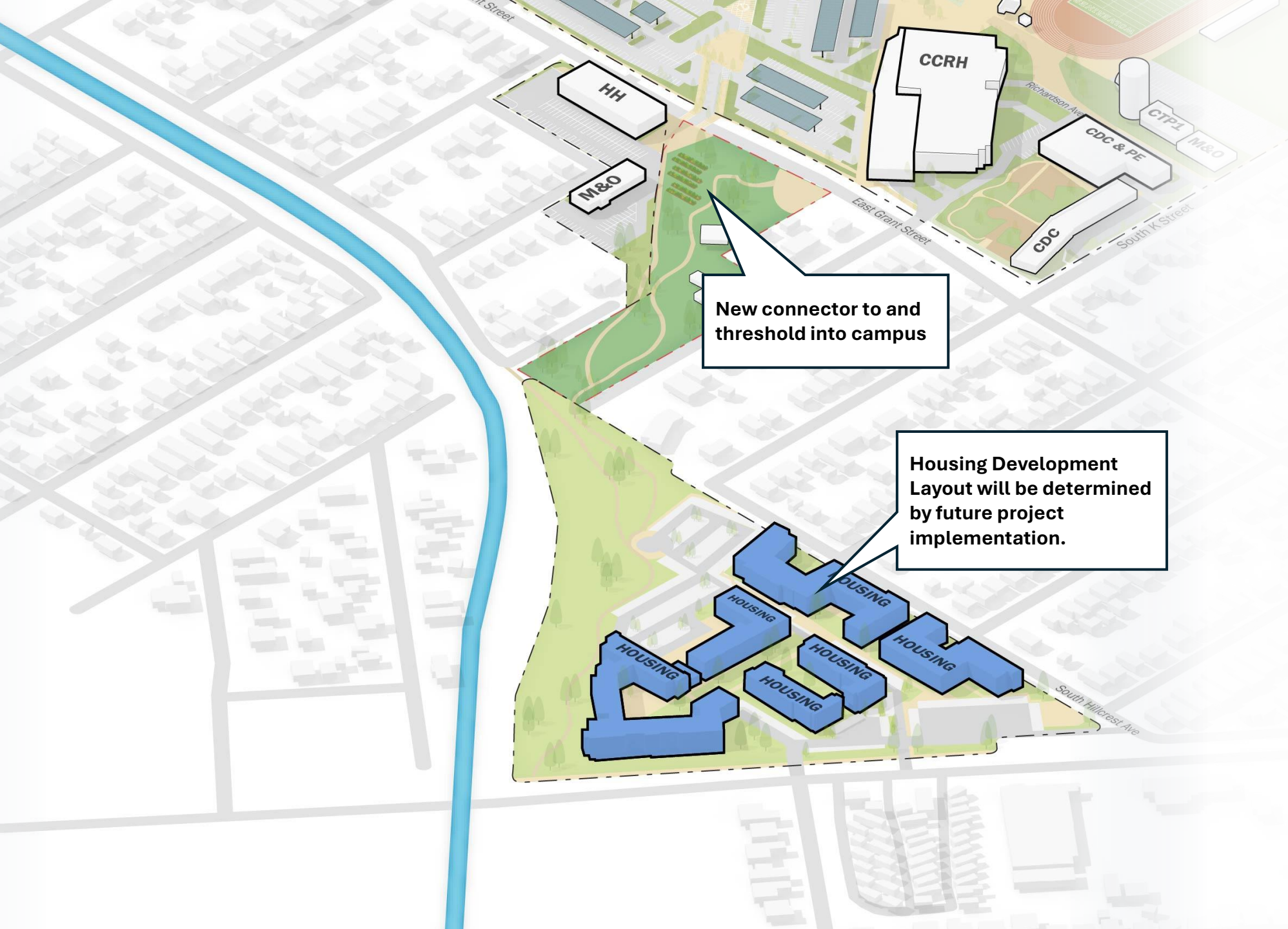

New connector to and threshold into campus

Housing Development Layout will be determined by future project implementation.

### Mixed-Use Site with Housing

#### Programs:

- Housing
- Flex/Community Housing
- Affordable Apartments
- Student Housing
- Campus/Community Green Connector

#### Sustainability:

- Social sustainability aspects
- Design for LEED/ZNE
- Site / Stormwater Improvements

#### Alignment with Education Plan:

- Student access to basic needs including housing
- Student success
- Increase revenue



## Hospitality Hub

**Size:**  
32,000 GSF

- Programs:**
- Event Space (up to 400 people)
  - Culinary Kitchen
  - Simulation Hotel Check-In
  - Space for Culinary and Baking Program
  - Non-profit and Community Programs office space
  - Flex Space
  - Community Garden

- Sustainability:**
- Design for LEED/ZNE
  - Site / Stormwater Improvements

- Alignment with Education Plan:**
- Bring the community to campus
  - Create experiential learning opportunities
  - Grow enrollment and improve program experience



**Parent Ed & CDC Building**

**Size:**  
35,000 GSF

- Programs:**
- Replaces CDC Modulars
  - Provides new and expanded space for Parent Ed. Center and CDC

- Sustainability:**
- Design for LEED/ZNE
  - Site / Stormwater Improvements

- Alignment with Education Plan:**
- Create experiential learning opportunities
  - Grow enrollment and improve program experience



**KVCR Additions**

**Size:**  
7,800 GSF

- Programs:**
- New Studio Expansion
  - New Classroom/Lab Expansion
  - Shared Storage

- Sustainability:**
- Sustainable materials in renovation/expansion

- Alignment with Education Plan:**
- Create experiential learning opportunities
  - Grow enrollment and improve program experience



### Community Hub

**Size:**  
16,000 GSF

- Potential Programs:**
- Community Space
  - Alumni Hall/Hall of Fame
  - Student Space

- Sustainability:**
- Design for LEED/ZNE
  - Site / Stormwater Improvements

- Alignment with Education Plan:**
- Bring the community to campus
  - Create spaces that foster student retention and recruitment



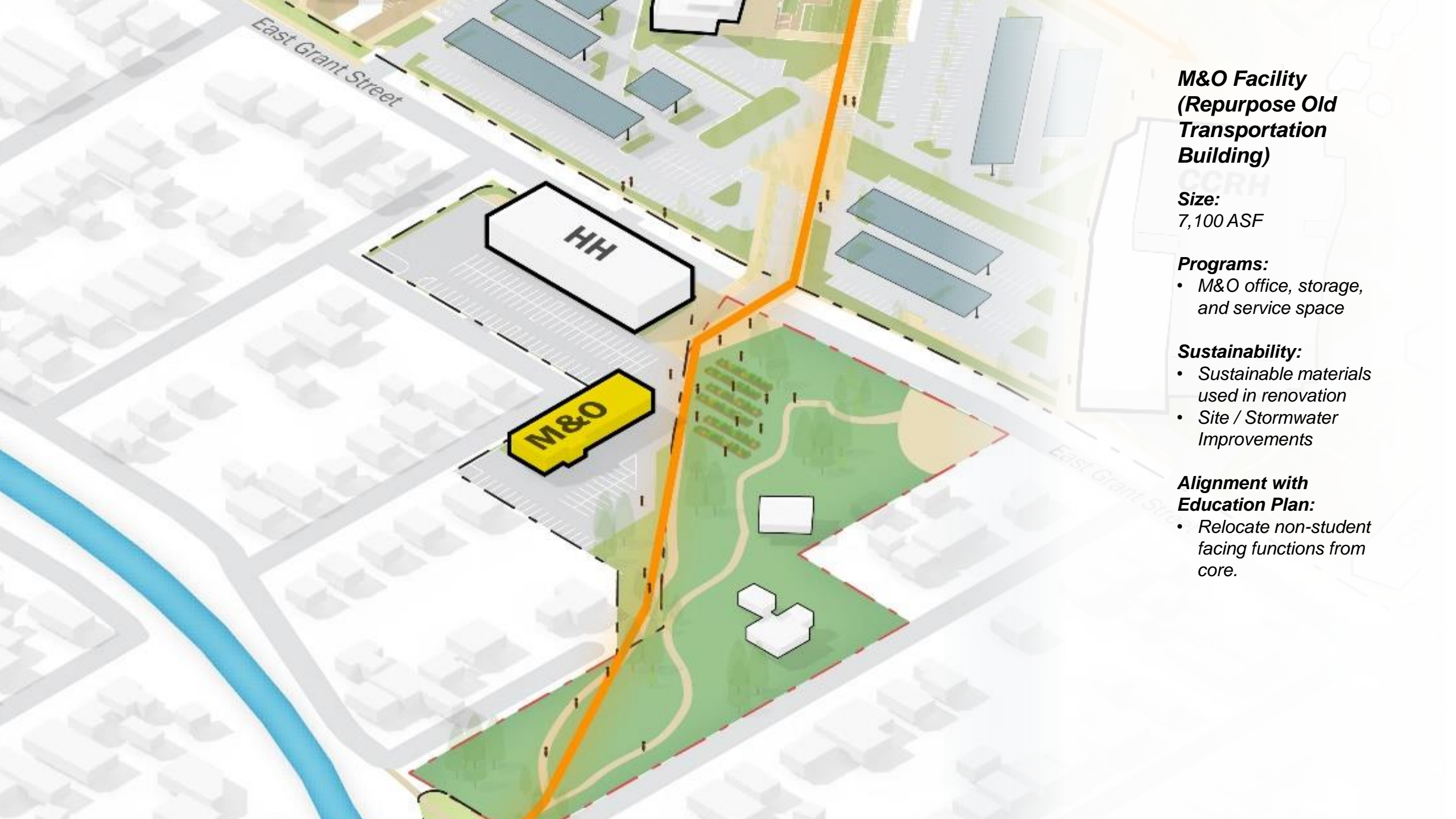

**M&O Facility  
(Repurpose Old  
Transportation  
Building)**

**Size:**  
7,100 ASF

- Programs:**
- M&O office, storage, and service space

- Sustainability:**
- Sustainable materials used in renovation
  - Site / Stormwater Improvements

- Alignment with Education Plan:**
- Relocate non-student facing functions from core.

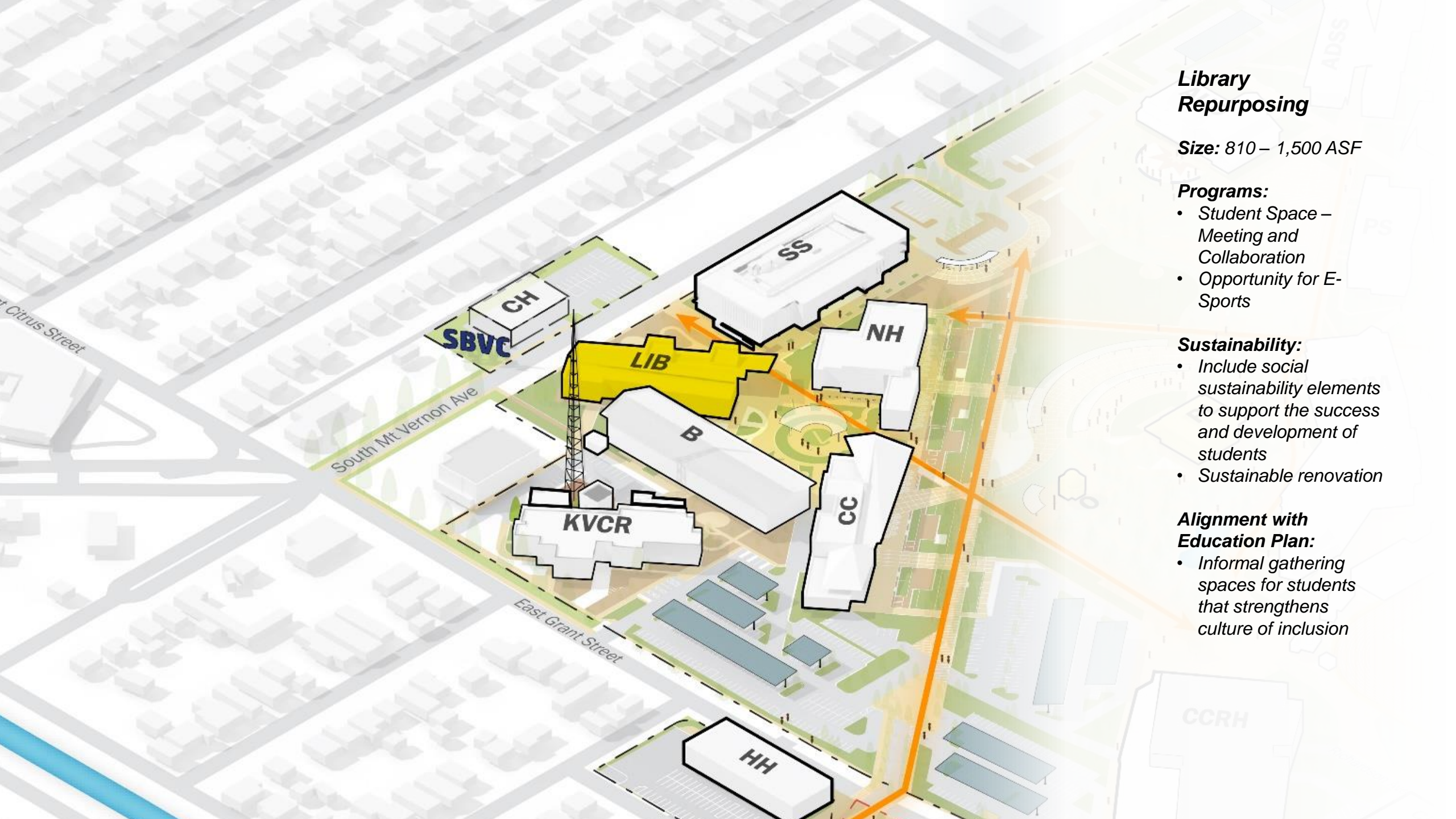

## **Library Repurposing**

**Size:** 810 – 1,500 ASF

### **Programs:**

- Student Space – Meeting and Collaboration
- Opportunity for E-Sports

### **Sustainability:**

- Include social sustainability elements to support the success and development of students
- Sustainable renovation

### **Alignment with Education Plan:**

- Informal gathering spaces for students that strengthens culture of inclusion



# Library Concept

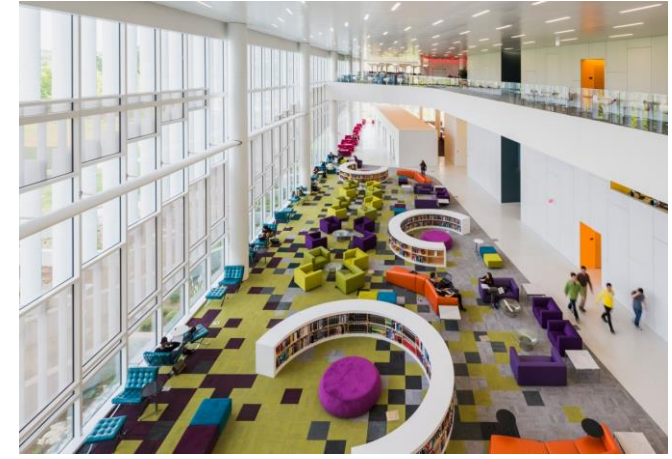
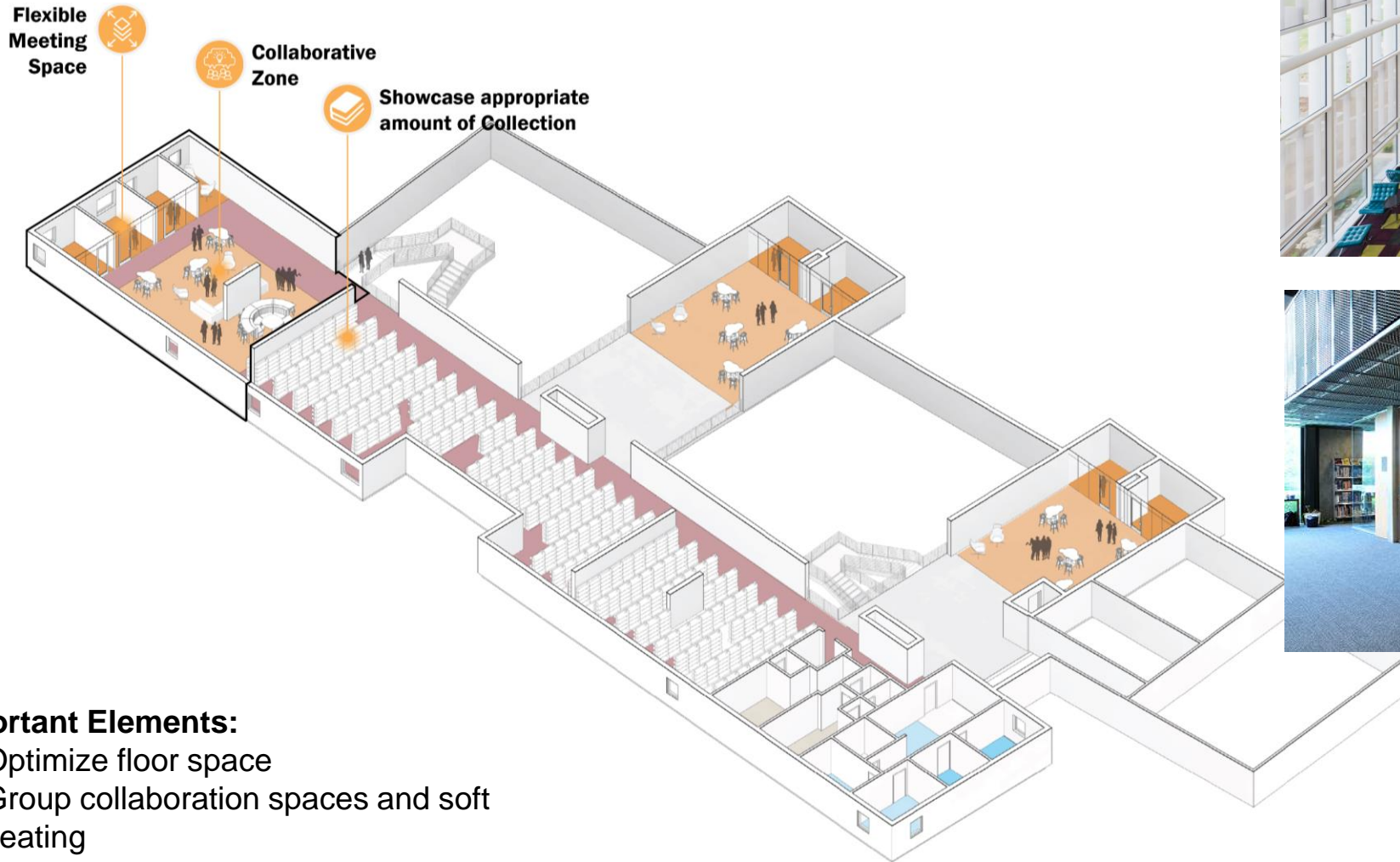

Library Floor 2

## Important Elements:

- Optimize floor space
- Group collaboration spaces and soft seating
- Study rooms and smaller private meeting spaces

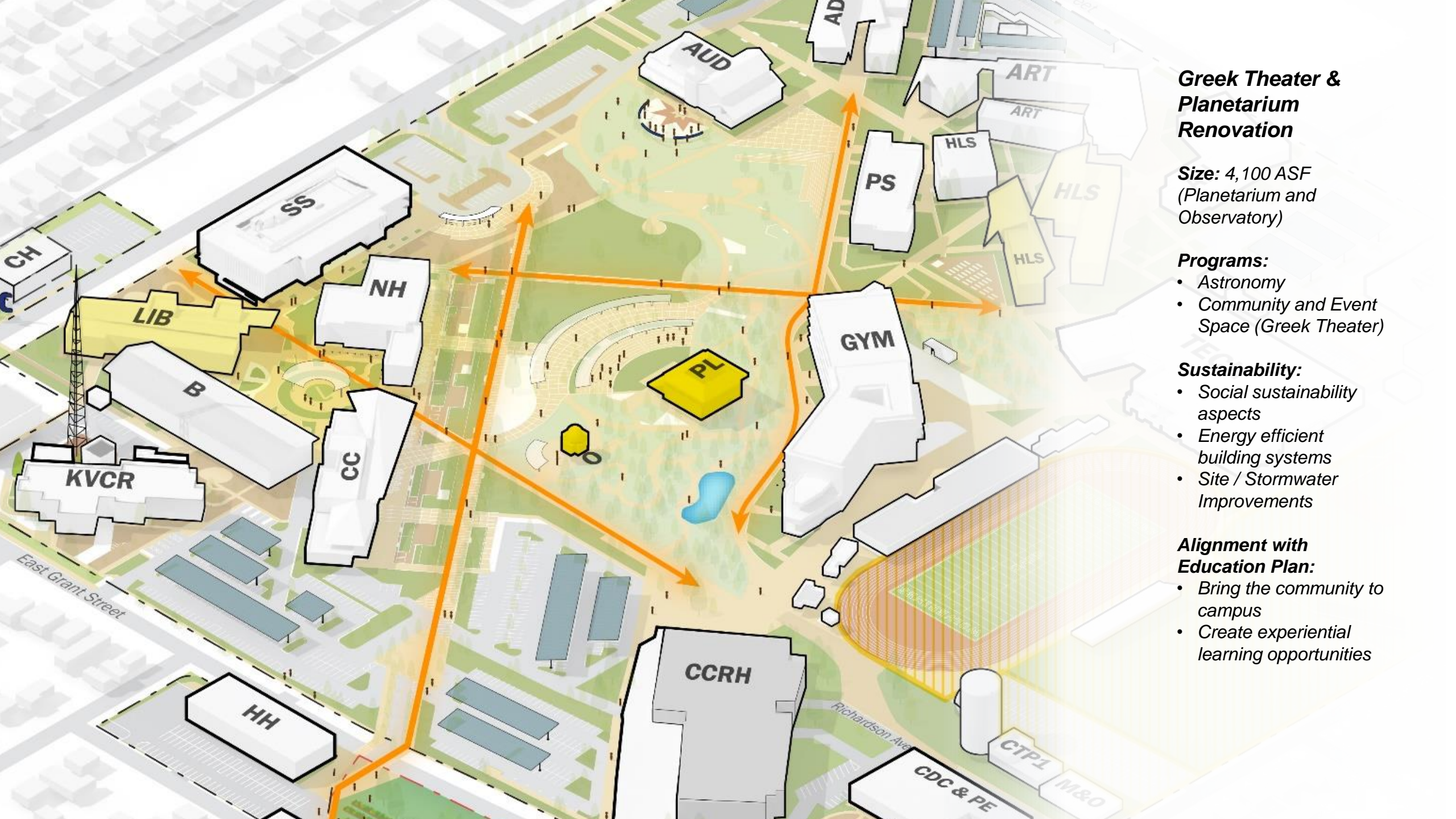

### **Greek Theater & Planetarium Renovation**

**Size:** 4,100 ASF  
(Planetarium and Observatory)

- Programs:**
- Astronomy
  - Community and Event Space (Greek Theater)

- Sustainability:**
- Social sustainability aspects
  - Energy efficient building systems
  - Site / Stormwater Improvements

- Alignment with Education Plan:**
- Bring the community to campus
  - Create experiential learning opportunities



# Greek Theater – Landscape Master Plan

Central Event Plaza / Event Lawn

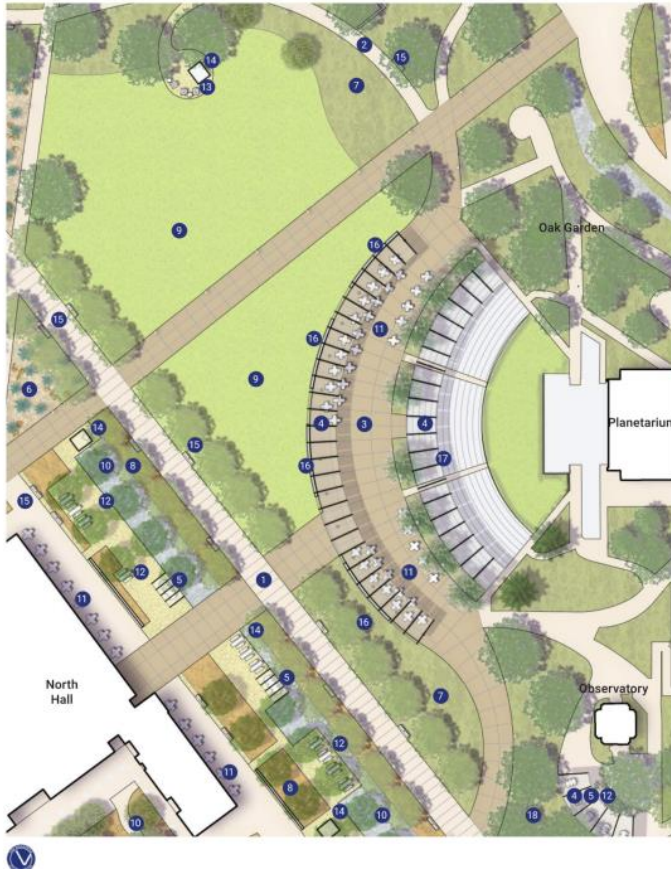

**Features**

- 1 Fault Line Promenade
- 2 Oak Trail
- 3 Central Event Plaza
- 4 Shade Structure
- 5 Outdoor Classroom
- 6 Mojave Desert Garden
- 7 Oak Savanna
- 8 Waterwise Planting
- 9 Event Lawn
- 10 Stormwater Garden
- 11 Cafe Seating
- 12 Collaboration Space
- 13 Informal Seating
- 14 Solar Powered Collaboration Table
- 15 Bench Seating
- 16 Seatwall
- 17 Shaded Greek Theater
- 18 Geology Garden

Central Event Plaza / Event Lawn - Sample Layout Scenarios

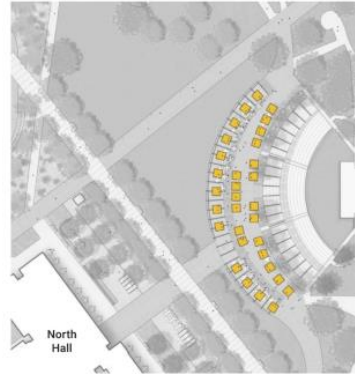

Scenario 1: Campus or Community Fair

- 16,268sf plaza
- 5,720sf plaza shade structure
- (32+) 10'x10' booths



Career Fair

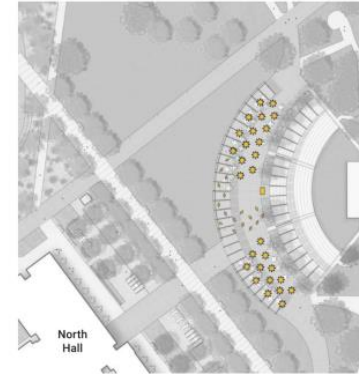

Scenario 2: 250 Person Catered Event

- (25+) 10 person tables
- (17+) cocktail tables
- 200sf stage, podium or speaker space
- 250 seated guests



Awards Ceremony

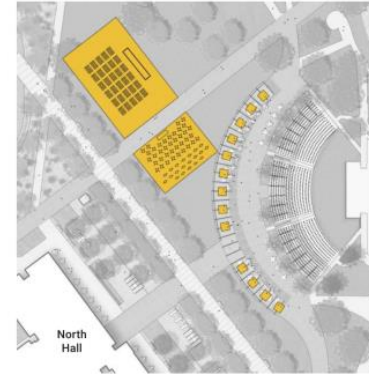

Scenario 3: Large Events

- 7200sf/500 person tent
- 4000sf/200 person tent
- 4,700sf amphitheater shade structure
- 1000 person amphitheater seating
- (20) 10'x10' booths



Tented Event

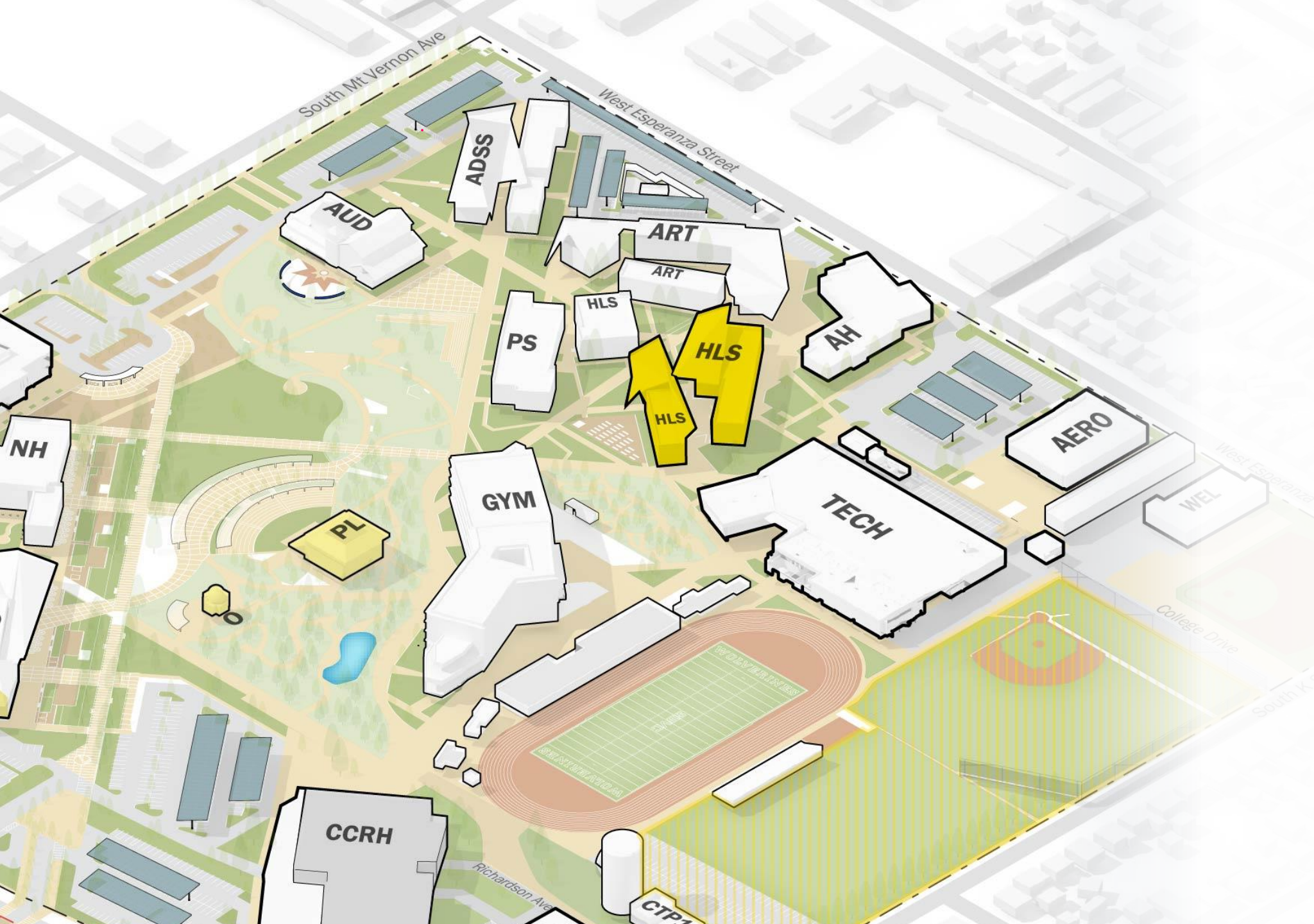

## Health & Life Sciences

**Size:** ~6,900 ASF

### **Programs:** “Community”

- Clinic spaces
- Pharmacy for Pharmacy Tech
  - Operating Room for Surge Tech
  - Blood Lab for Phlebotomy
  - Office Space for Medical Billing & Coding

### **Sustainability:**

- Sustainable materials used in renovation
- Building efficiency improvements where possible

### **Alignment with Education Plan:**

- Increase student enrollment for impacted programs
- Space for new and medical health-related programs
- Create experiential learning opportunities



# Health & Life Sciences Concept

## Potential Elements:

- Medical Billing & Coding Offices
- Expansion of Simulation/Lab Spaces for Nursing Growth
- Simulation Pharmacy
- Simulation Blood Lab
- Surge Tech Space
- Sim. Waiting Room

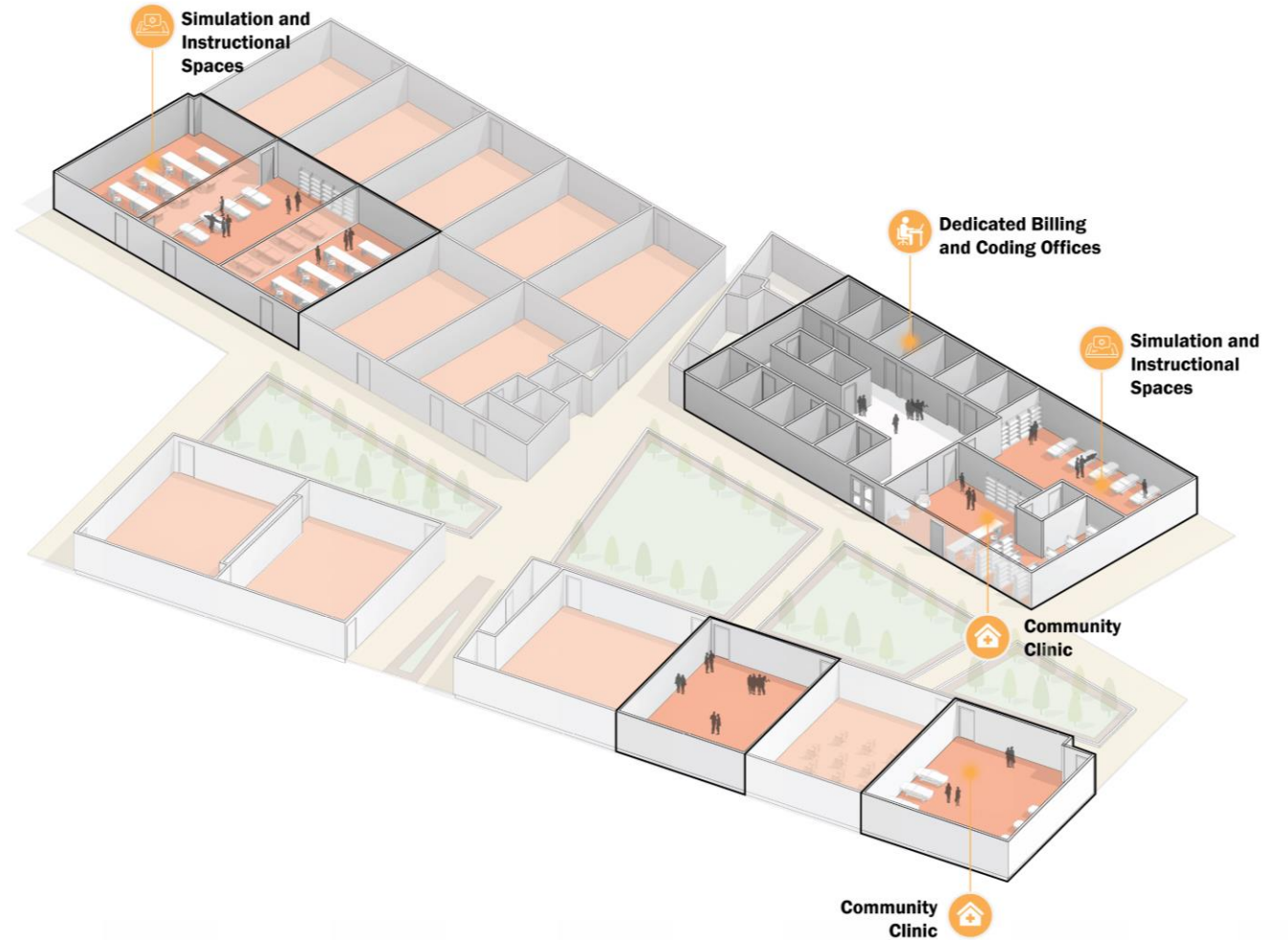

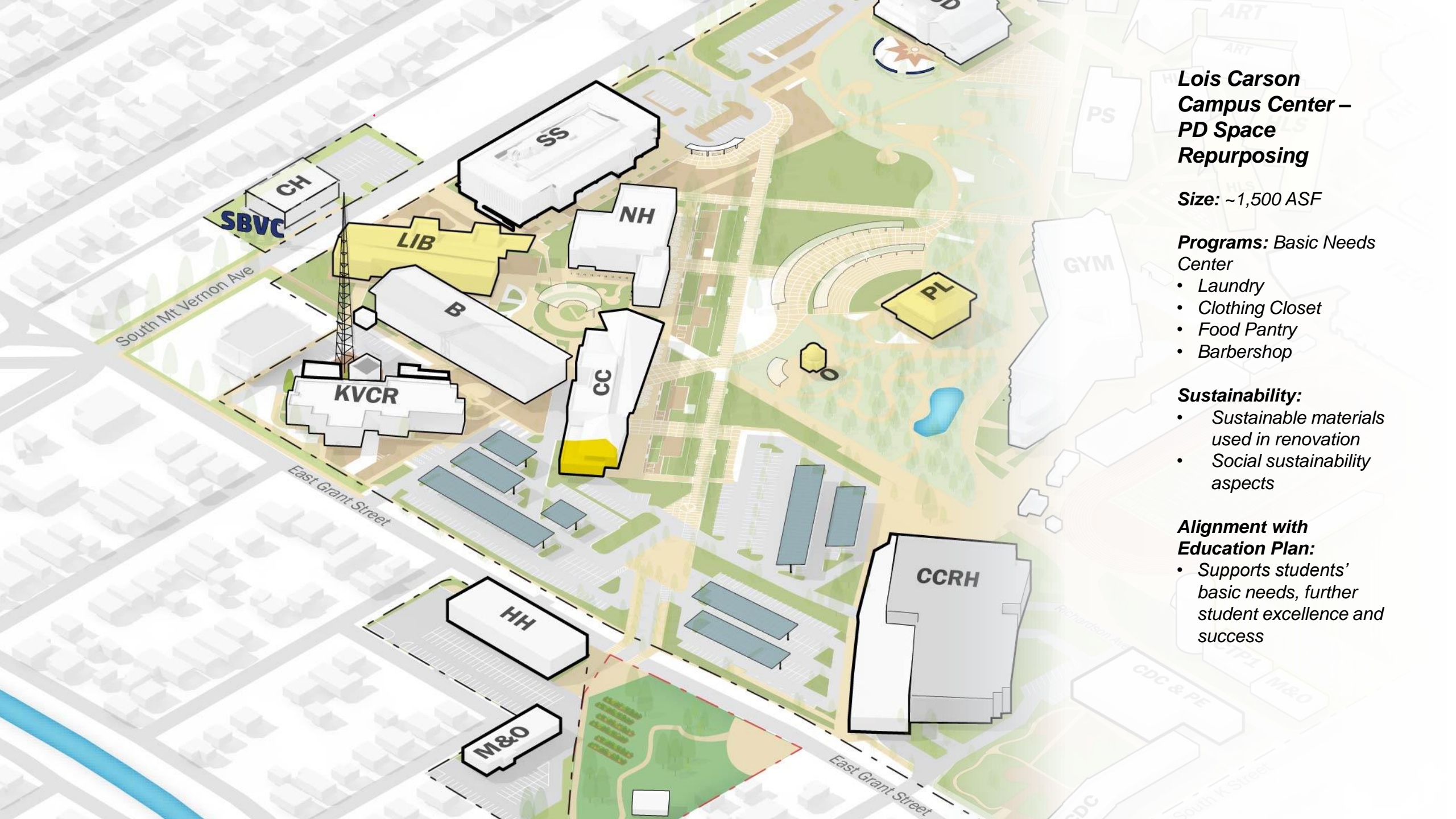

**Lois Carson  
Campus Center –  
PD Space  
Repurposing**

**Size:** ~1,500 ASF

**Programs:** Basic Needs  
Center

- Laundry
- Clothing Closet
- Food Pantry
- Barbershop

**Sustainability:**

- Sustainable materials  
used in renovation
- Social sustainability  
aspects

**Alignment with  
Education Plan:**

- Supports students’  
basic needs, further  
student excellence and  
success



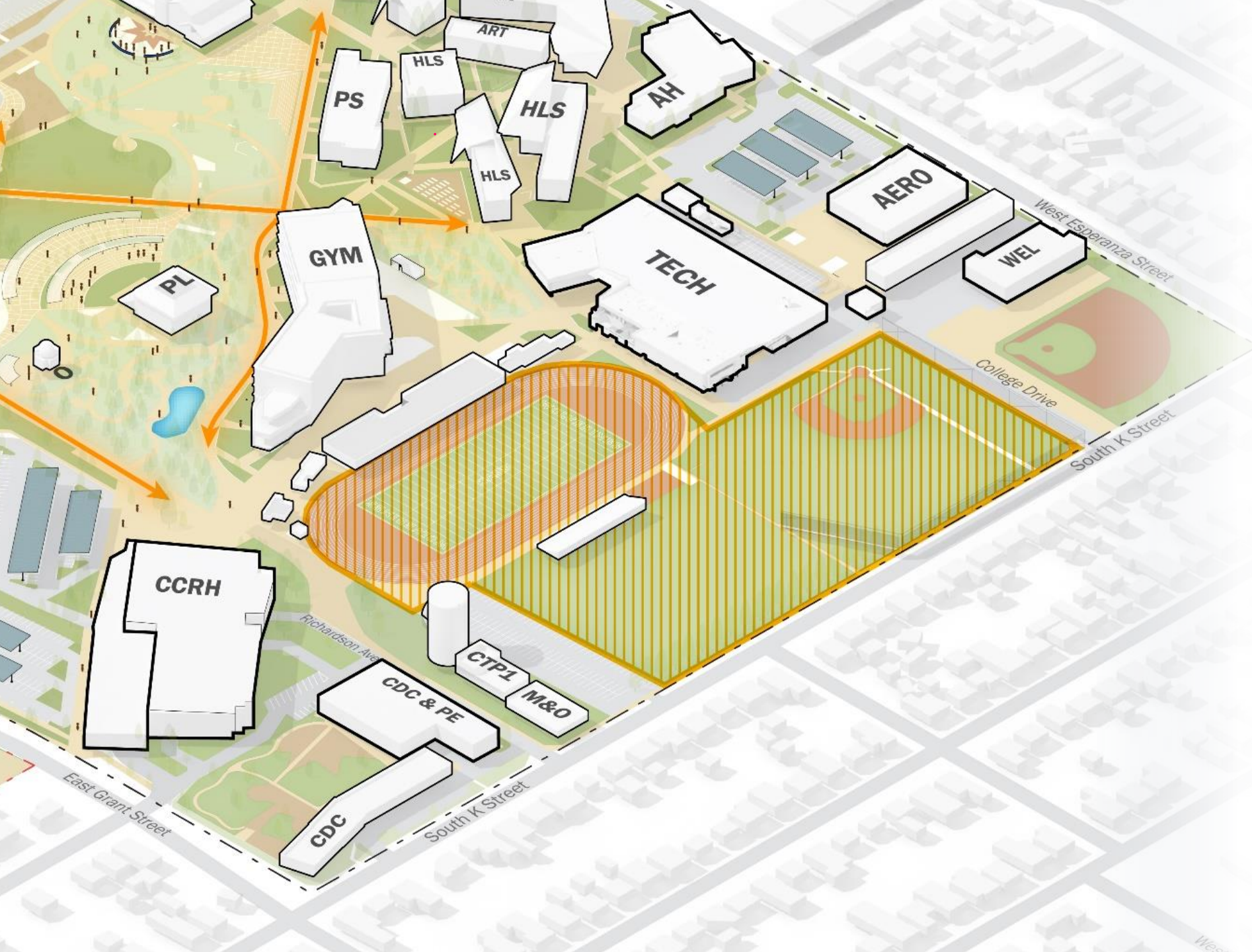

## **Athletic Fields Renovation**

### **Programs: Field Upgrades**

- Soccer Field
- Baseball Field
- Track resurfacing and Stadium Field

### **Sustainability:**

- Site / Stormwater Improvements

### **Alignment with Education Plan:**

- Increase student enrollment and retention
- Brings community on to campus



# Alignment with Sustainability MP

## What's already happening?

- LEED Platinum and ZNE Buildings in design
- Site and stormwater improvements

## What's next?

- **Implement the Sustainability Master Plan and Landscape Master Plan**
- Moving toward electrification, away from gas.
- Embodied Carbon reduction
- Retro-commissioning and retrofitting older buildings
- EV Charging in alignment with Title 24

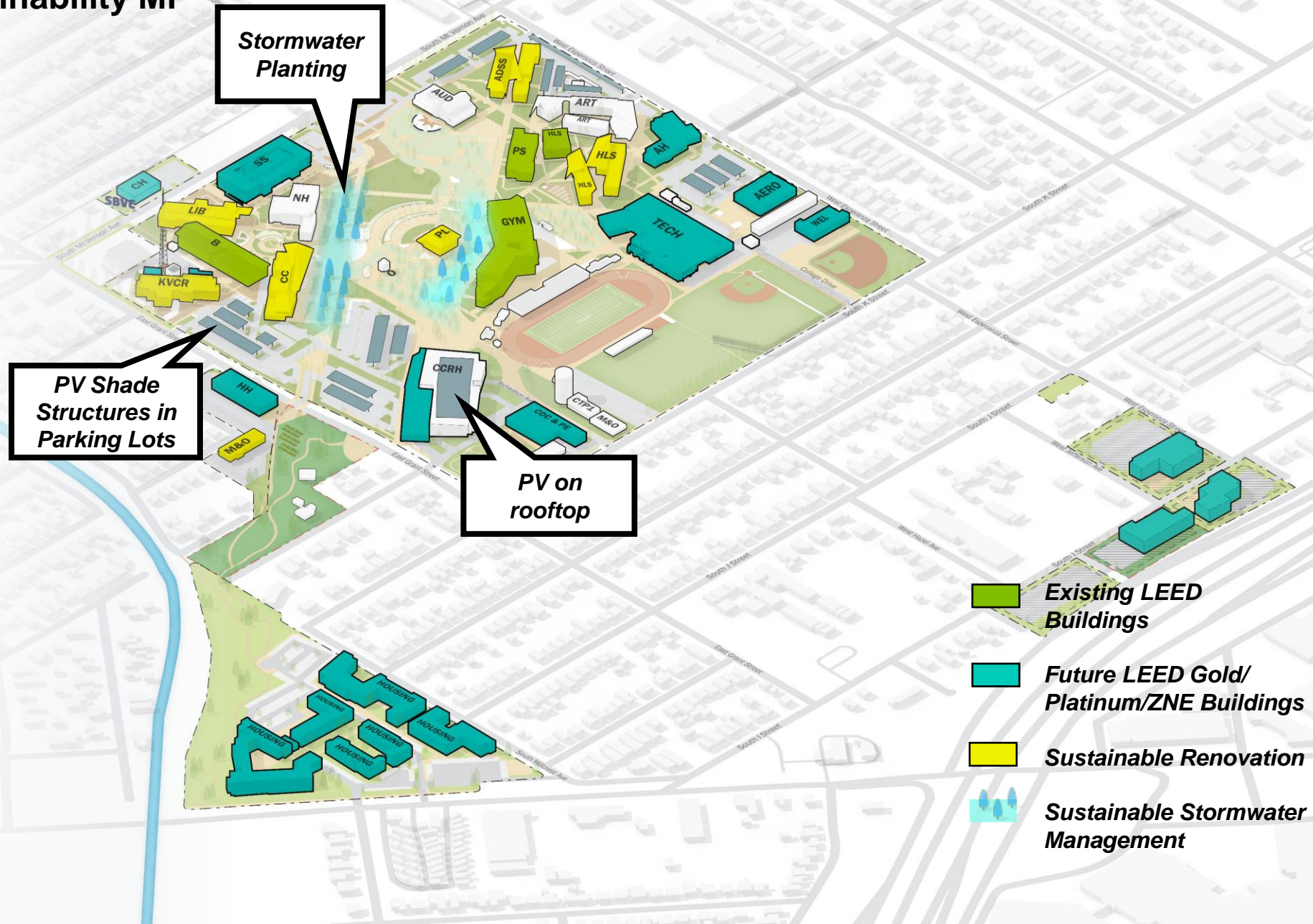



# Placemaking

## Key Elements

- **Implement the Landscape Master Plan**
  - Arrival and Wayfinding Improvements
  - Programmatic Use of Outdoor Space – Outdoor Classrooms, Collaboration Space
  - Sustainable Landscape Elements
  - Event and Gathering Space
  - Thematic Gardens
- **Implement the Wayfinding Master Plan**
  - Signage and Gateway Improvements

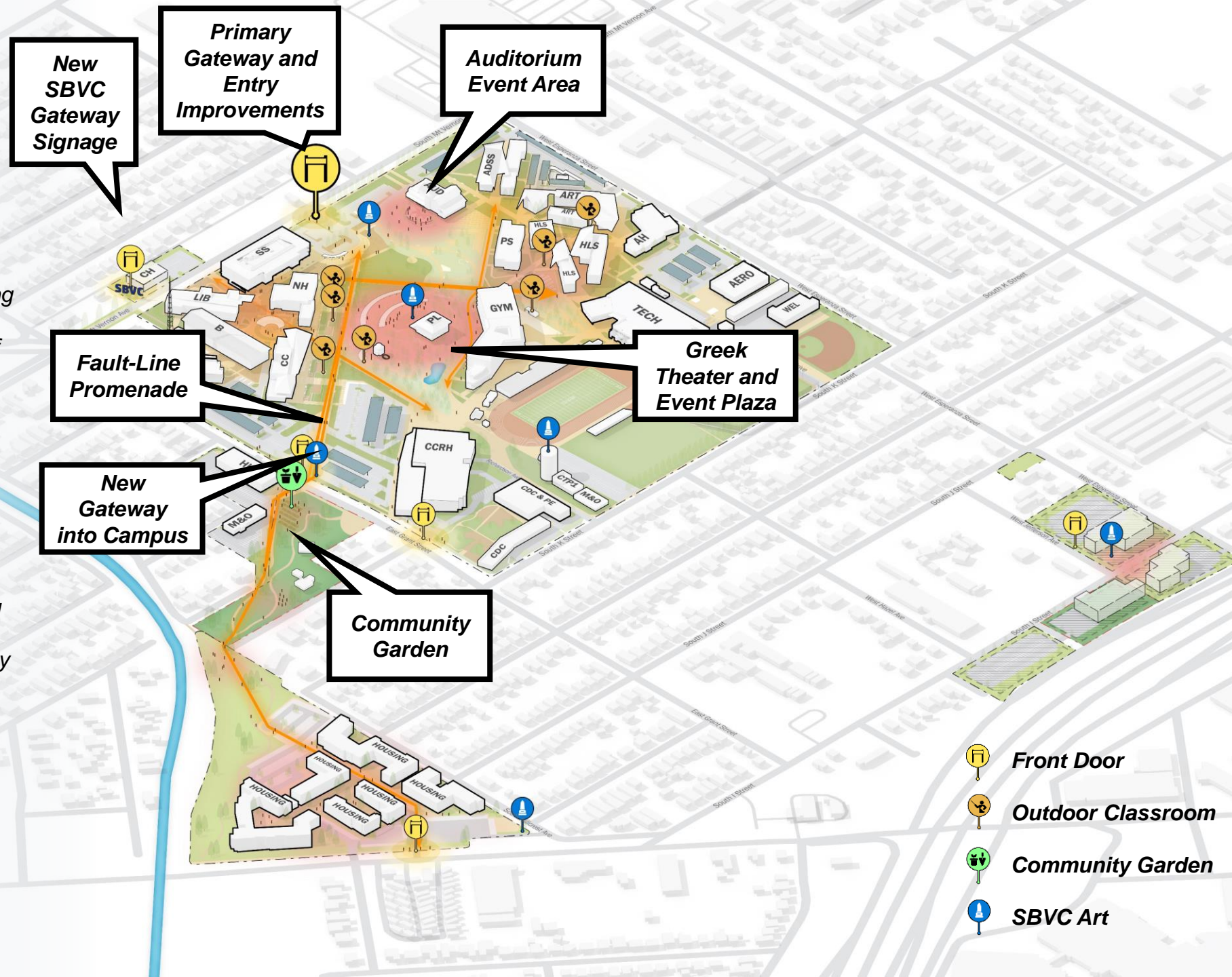



# Landscape Master Plan Projects

## Highlights:

- Fault Line Promenade
- Geology Garden and Educational Gardens
- Outdoor Classrooms
- Stormwater Treatment
- Entry/Arrival Improvements
- Event Plaza and Lawn
- Greek Theater





# Active Learning Retrofits

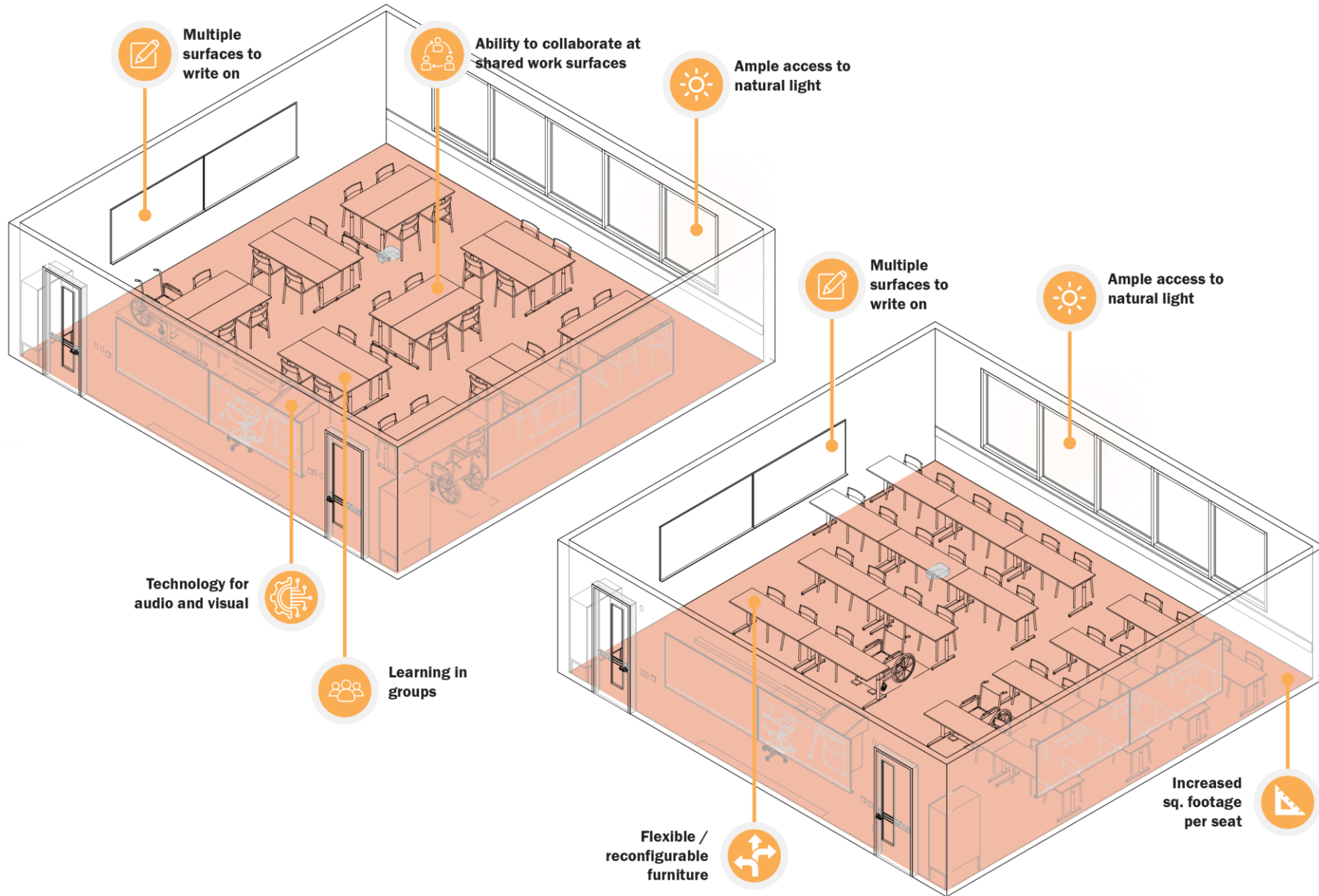



# New Construction & Renovations of Classroom Space

## Design for active learning and flexibility

- Flexible furniture arrangements and technology that supports informal teaching styles and collaboration
- Wall partitions that make rooms adaptable



## Increase efficiency and accommodate common classroom sizes

- Where possible, increase timeframes in which classes are offered to maximize classroom use
- Class sizes tend to be smaller than classroom capacities; consider course schedule in renovations and new construction; utilize partitions and flexible arrangements to adapt existing rooms





# Circulation and Parking

## Total Parking Count:

~1,780

(Not Including Housing Parcel)

- Net increase of 537 spaces (from Phase 00 Baseline)

Primary drop-off

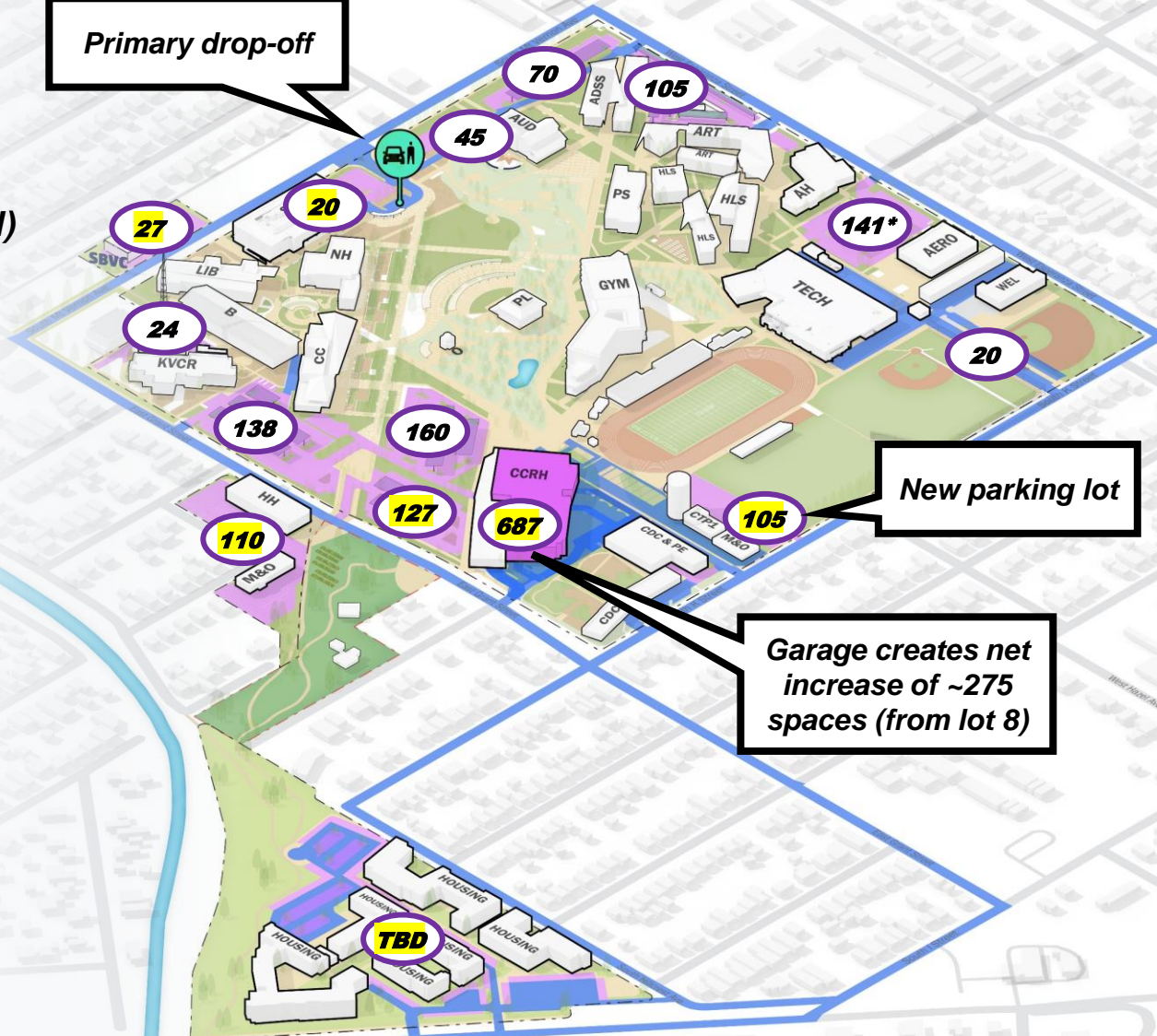

New parking lot

Garage creates net increase of ~275 spaces (from lot 8)



# Copy of the First Draft FMP

<https://sbccdpmo.egnyte.com/dl/jW38WmZNq6>







**Questions or Comments?**

**Reach out to:**

**Yash Patel**

**[ypatel@sbccd.edu](mailto:ypatel@sbccd.edu)**

